

Horizontal End-Suction Pumps

SBG1101...1103

Axial/semi-open impellers

SBG1101...1103

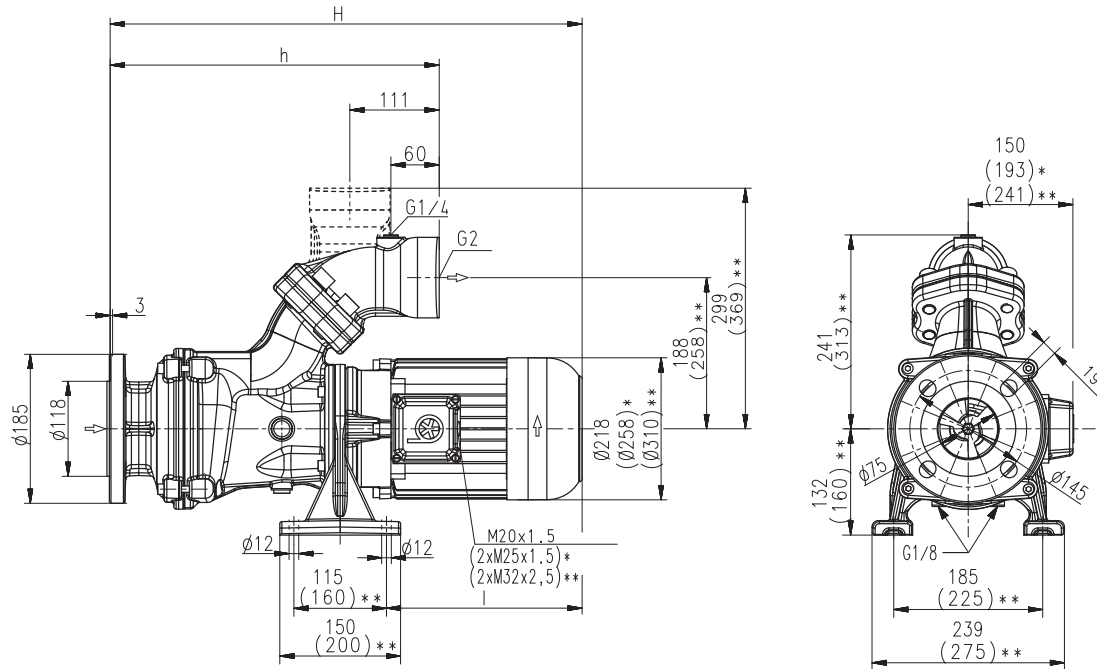

*) Dimensions for SBG1102

**) Dimensions for SBG1103

Type	Vol. del. at manom. del. head	Dimensions		Length	Weight	Power kW	Voltage 3 ~ V	Fre- quen- cy Hz	Current A	Speed 1/min
	l/min / m	H mm	h mm	l mm	kg					
SBG1101	900/12	705	413	358	73	5.0	220-240 380-415	50 50	17.3 10.0	2920 2920
SBG1102	900/21	863	492	437	117	5.75 9.0	460 380-415	60 50	9.5 16.7	3520 2955
SBG1103	900/35	951	643	422	142	10.3 13.0 15.0	460 380-415 460	60 50 60	15.8 24.2 23.6	3550 2960 3560

Horizontal End-Suction Pumps

are centrifugal inline pumps with a compact design where the impeller is mounted onto the extended motor shaft. These pumps are not self-priming and must be gravity fed. All pumps are equipped with a single mechanical seal. Upon request a second mechanical seal is available to allow for dry-running (-GD). This pump series is designed for horizontal installations next to a tank and for pumping **highly air entrained coolant and cutting oils**, as they occur in **high speed grinding applications**. The SBG pumps are equipped with the user-friendly 45 degree **flange** connection which allows for either vertical or horizontal pipe connection and the connection of a pressure gauge with G 1/4. For more information see mechanical features within the technical information section.

Applications

Types of fluid
 coolants
 cooling/cutting oils
 grinding oils
 Kinematic viscosity
 ...45 mm²/s (45 cSt)
 Pumping temperature
 0...80° C

Construction

Pump body	cast iron
Cover	cast iron
Impeller axial	cast steel
Impeller radial	cast steel
Shaft	steel
Mechanical seal	SiC
Noise level	
SBG1101	72 dBA
SBG1102...SBG1103	75 dBA

