

# Technical Data Sheet



## S64 SERIES HYDRAULIC HOIST

### Hydraulic Well Mount Hoist Cylinders

The S64 series hydraulic hoist is designed for the most demanding applications for tipper bodies on both trucks and trailers.

From initial engineering to the finished unit, we combine top-grade materials, precise component production and thorough testing to produce a high quality, dependable and economical product.

#### Suits:

All tipper body applications.

## Product Features

- **All Stages Hard Chrome Plated**  
To provide maximum durability and long life.
- **Quality Hallite and Kaden Seals Fitted**  
Designed for superior reliability.
- **Last Stage Blanked**  
No “bleeding” required to reduce time and cost at installation.
- **Increased Overlaps**  
Provides greater stability and longer life.
- **Low Closed Heights**  
Enables interchangeability with other brands.
- **Larger Diameter Stages**  
Provides an increased lifting capacity.
- **Higher Grade Steel Used**  
To provide greater durability.
- **Standard Mountings**  
Industry standard bolt patterns top and bottom for ease of changing out.

POWAUTO

DAVID BROWN  
HYDRAULICS

HYDRECO®

HYDRECO  
POWAUTO

ADVANCED HYDRAULIC TECHNOLOGIES

[www.hydreco.com](http://www.hydreco.com)

# Technical Data Sheet

Designation	Stroke	CTC Height 'A'	Overall Height 'C'	Pivot Length for 48°	Weight kg	Swept Volume L
S64-149-3-2720	2720	1162	1312	3313	158	40
S64-149-3-2870	2870	1212	1362	3496	163	42
S64-149-3-3055	3055	1274	1424	3723	169	45
S64-149-3-3226	3226	1331	1481	3932	175	47
S64-149-3-3385	3385	1384	1534	4126	180	49
S64-149-3-3560	3560	1442	1592	4338	186	52
S64-149-3-3745	3745	1504	1654	4565	192	54
S64-149-3-3930	3930	1566	1716	4791	200	57
S64-149-3-4500	4500	1756	1906	5487	216	66
S64-149-4-3060	3060	1027	1177	3734	136	40
S64-149-4-3260	3260	1077	1227	3978	141	42
S64-149-4-3460	3460	1127	1277	4222	146	44

Designation	Stroke	CTC Height 'A'	Overall Height 'C'	Pivot Length for 48°	Weight kg	Swept Volume L
S64-169-4-3954	3954	1260	1410	4824	196	67
S64-169-4-4336	4336	1356	1506	5293	208	73
S64-169-4-4494	4494	1396	1546	5488	213	76
S64-169-4-5020	5020	1526	1676	6127	230	85
S64-169-4-5640	5640	1681	1831	6878	320	98
S64-191-4-5789	5789	1736	1946	7062	330	127
S64-191-4-6370	6370	1880	2090	7765	354	140
S64-191-4-6825	6825	1994	2204	8321	373	148
S64-191-4-7105	7105	2064	2274	8662	384	156
S64-191-5-6244	6244	1544	1714	7617	301	123
S64-191-5-6495	6495	1593	1763	7916	310	128
S64-191-5-6833	6833	1661	1831	8330	321	134

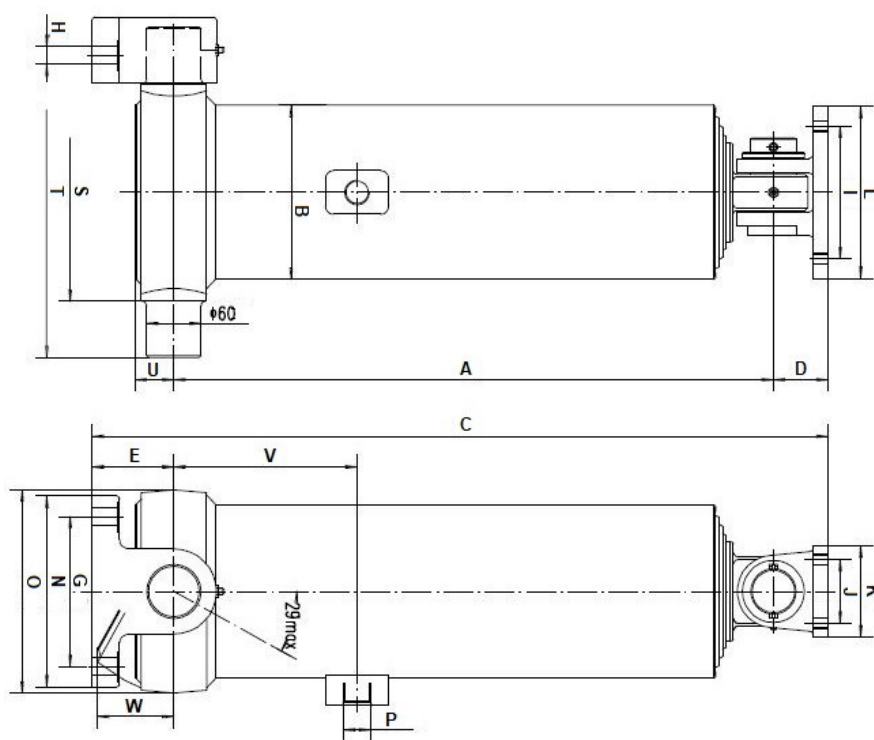

Mounting dimensions of upper bracket

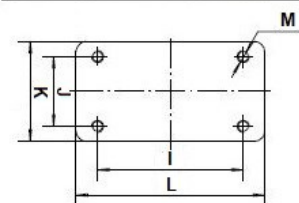

Mounting dimensions of bottom bracket

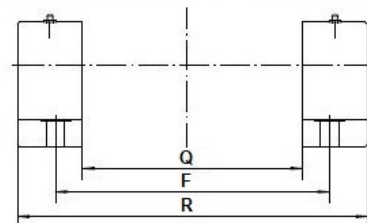

Series	Dimensions																			Hoist Thrust at 200 Bar
	'B'	'D'	'E'	'F' x 'G'	'H'	'T' x 'J'	'K'	'L'	'M'	'N'	'O'	'P'	'Q'	'R'	'S'	'T'	'U'	'V'	'W'	
S64-149	170	60	90	241 x 95	17	146 x 70	100	189	M12	152	201	1 1/16" UNO	203	341	201	325	43	195	79	35.6 Tonne
S64-169	192	60	90	307 x 165	20	146 x 70	100	189	M12	210	224	1 5/16" UNO	242	386	240	370	43	202	84	45.8 Tonne
S64-191-4	215	60	150	345 x 165	20	184 x 95	130	222	M16	210	249	1 5/16" UNO	252	396	250	378	50	195	97	58.5 Tonne
S64-191-5	215	60	110	345 x 165	20	184 x 95	130	222	M16	210	249	1 5/16" UNO	252	396	250	378	50	195	97	58.5 Tonne

Maximum Pressure = 200Bar

Doc: S64—11/17

POWAUTO

DAVID BROWN HYDRAULICS

HYDRECO®

HYDRECO

POWAUTO

ADVANCED HYDRAULIC TECHNOLOGIES

www.hydreco.com