

# Horizontal End-Suction Pumps

## SBM140...450

### Semi-open impellers

#### SBM140...450

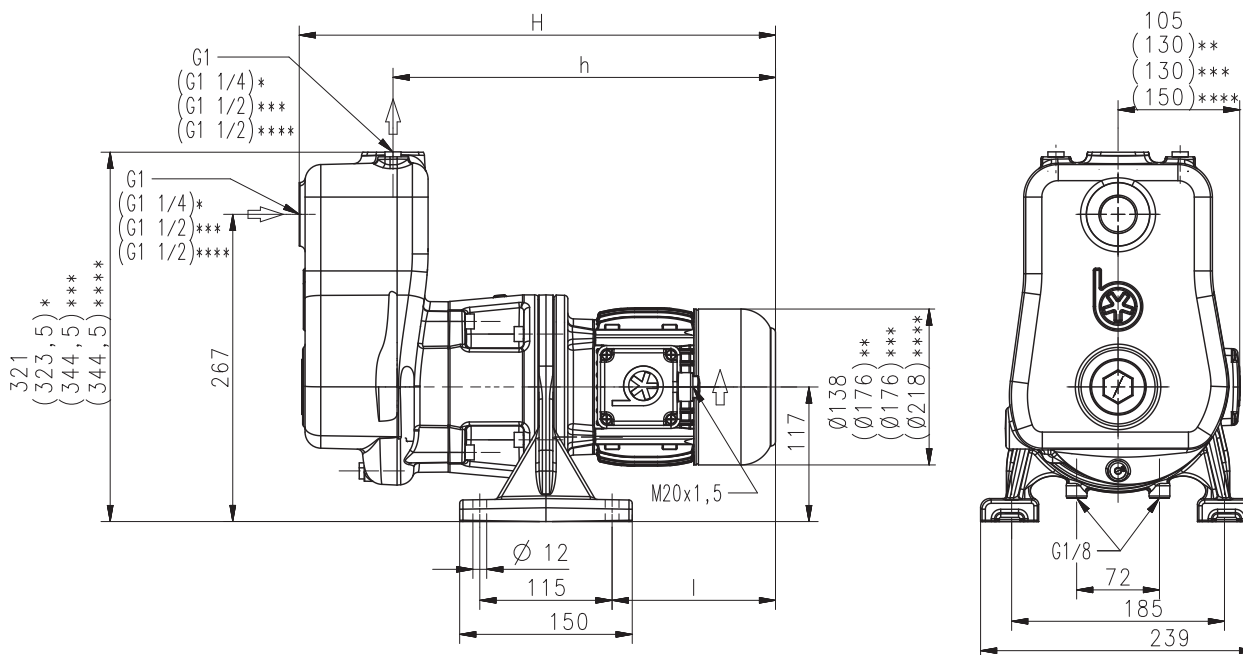

\*) Dimensions for SBM315, SBM315/60 Hz

\*\*) Dimensions for SBM315/60Hz

\*\*\*) Dimensions for SBM450

\*\*\*\*) Dimensions for SBM450/60Hz

Type	Vol. del. at manom. del. head l/min / m	Dimensions		Length l mm	Weight kg	Power kW	Voltage 3 ~ V	Fre- quen- cy Hz	Current A	Speed 1/min
		H mm	h mm							
<b>SBM140</b>	100/8	419	332	142	27	0.54	220-240 380-420	50 50	2.42	2800
									1.40	2800
<b>SBM140/60Hz</b>	120/12	461	375	184	29	1.06	460	60	2.1	3440
<b>SBM315</b>	200/9	497	399	211	32	1.1	220-240 380-415	50 50	4.33	2850
									2.50	2850
<b>SBM315/60Hz</b>	240/14	542	444	256	46	1.95	460	60	3.5	3480
<b>SBM450</b>	240/15	586	476	289	48	1.9	220-240 380-415	50 50	6.84	2900
									3.95	2900
<b>SBM450/60Hz</b>	270/24	625	515	328	55	3.8	460	60	6.4	3520

### Horizontal End-Suction Pumps

are centrifugal inline pumps with a compact design where the impeller is mounted onto the extended motor shaft.

These pumps are **self-priming after initial filling.**

All pumps are equipped with a single mechanical seal.

SBM Pumps are mounted **next to or on top** of the tank and they are suitable for pumping **air entrained coolant fluids**, such as **water-soluble coolants or cutting oils**, as they occur in **high speed turning, milling or grinding applications.**

For more information see mechanical features within the technical information section.

### Applications

Types of fluid  
coolants  
cooling/cutting oils  
Kinematic viscosity  
...45 mm<sup>2</sup>/s (45 cSt)  
Pumping temperature  
0...60° C  
Suction height  
5 m

### Construction

Cover	cast iron
Impeller radial	cast steel
Shaft	steel
Mechanical seal	SiC

