

# Immersion Pumps

## TE/STE141...146

### Semi-open impellers

#### TE141, 142

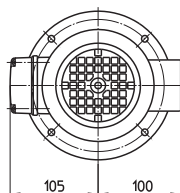
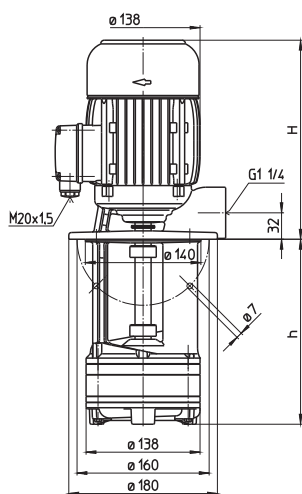

#### STE141...146

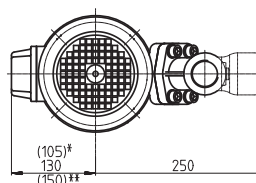
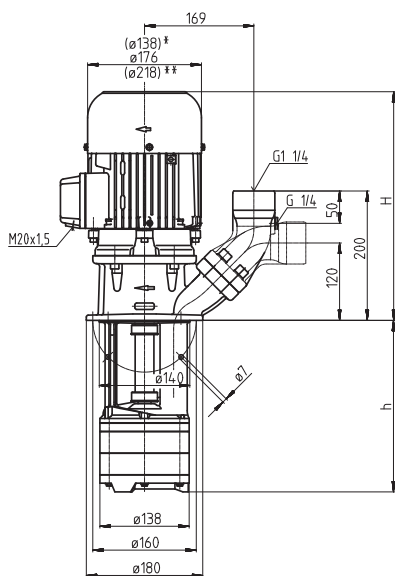

\*) Dimensions for STE141, 142  
 \*\*) Dimensions for STE146

Type	Vol. del. at manom. del. head l/min / m	Height H mm	Depth of immersion h mm	Weight kg	Power kW	Voltage 3~ V	Fre- quen- cy Hz	Current A	Speed 1/min
<b>TE141/200</b>	80/11	223	200	13.5	0.5	220-240	50	2.42	2800
<b>270</b>			270	14.5		380-420	50	1.40	2800
<b>350</b>			350	15.5		460	60	1.40	3300
<b>440</b>			440	17.0					
<b>550</b>			550	18.5					
<b>TE142/150</b>	80/20	291	150	16.5	1.1	220-240	50	4.33	2850
<b>230</b>			230	18.0		380-415	50	2.50	2850
<b>300</b>			300	18.5	1.27	460	60	2.4	3440
<b>380</b>			380	19.5					
<b>470</b>			470	21.0					
<b>580</b>			580	23.0					
<b>STE141/120</b>	80/11	293	120	17.5	0.54	220-240	50	2.42	2800
<b>200</b>			200	18.5		380-420	50	1.40	2800
<b>270</b>			270	19.5		460	60	1.40	3300
<b>350</b>			350	20.5					
<b>440</b>			440	22.0					
<b>550</b>			550	23.5					
<b>STE142/150</b>	80/20	361	150	21.5	1.1	220-240	50	4.33	2850
<b>230</b>			230	23.0		380-415	50	2.50	2850
<b>300</b>			300	23.5	1.27	460	60	2.4	3440
<b>380</b>			380	24.5					
<b>470</b>			470	26.0					
<b>580</b>			580	28.0					
<b>STE143/190</b>	80/33	406	185	32	1.7	220-240	50	6.24	2890
<b>270</b>			265	33		380-415	50	3.60	2890
<b>340</b>			335	34	1.95	460	60	3.5	3480
<b>420</b>			415	35					
<b>510</b>			505	36					
<b>620</b>			615	38					
<b>STE144/220</b>	80/45	439	220	36	2.2	220-240	50	7.8	2890
<b>300</b>			300	37		380-415	50	4.5	2890
<b>370</b>			370	38	2.55	460	60	4.4	3480
<b>450</b>			450	39					
<b>540</b>			540	41					
<b>650</b>			650	42					
<b>STE145/270</b>	80/56	439	270	40	2.6	220-240	50	9.30	2880
<b>350</b>			350	41		380-415	50	5.35	2880
<b>420</b>			420	42	2.94	460	60	5.1	3480
<b>500</b>			500	43					
<b>590</b>			590	44					
<b>700</b>			700	46					
<b>STE146/300</b>	80/70	478	305	52	4.0	220-240	50	14.50	2920
<b>380</b>			385	53		380-415	50	8.35	2920
<b>450</b>			455	54	4.55	460	60	7.9	3520
<b>530</b>			535	55					

### Immersion Pumps

are plain centrifugal pumps with the impeller fitted on the driving shaft extension. They are mounted on top of the container, the pump extension being immersed in the coolant.

The dimensions are based on standard specification **EN 12157**.

The maximum coolant level must stay a few mm/inches below the mounting flange.

The STE serie offers a **(SAE) flange** with pressure gauge connection port.

The flange can be rotated for either horizontal or vertical pipe connections.



All types are also available as quick-suctioning immersion pumps equipped with "BRINKMANN's Suction De-aeration System". See series TL/STL.

### Applications

Types of fluid  
coolants  
cooling/cutting oils

Kinematic viscosity  
...45 mm<sup>2</sup>/s (45 cSt)

Pumping temperature  
0...60° C

### Construction

Pump body	cast iron
Cover	cast iron PPS (TE141, STE141)
Impellers	PPS
Shaft	steel

Optional: Cover	cast iron (TE141, STE141)
--------------------	------------------------------

Suction cover Impellers	with threaded inlet brass
----------------------------	------------------------------

Other materials	cast steel on request
-----------------	--------------------------

Noise level	
TE141...STE142	60 dBA
STE143...STE145	68 dBA
STE146	73 dBA

